

Hubble Middle School



Middle School Pre-bond Planning, Programming, and Design

Registered for LEED for Schools®
Silver Certification

Hubble Middle School is one of the nation’s first schools designed and built to LEED for Schools® standards. The 190,000 SF school showcases the latest in program-driven middle school design, and serves 1,078 students.

Program-driven Design

The three-story classroom building brings each grade its own area with storage, offices, labs, and computer facilities. A glass-enclosed bridge connects this facility with the one-story main building, which includes community spaces such as large and small gyms, a fitness center, and a 450-seat auditorium.

All spaces are designed with Hubble’s program and instructional delivery methods in mind. *Collaboration* zones outside of classrooms promote cooperative learning and student socialization. Teachers can use *team rooms* to strategize and create smaller schools within the school. The facility also offers six specialized instruction spaces per floor.

A Pioneer in Sustainability

From the wetland vegetation that surrounds it to the high-performance systems within it, Hubble Middle School sets a standard for energy-efficiency and environmental respect.

The school’s green features support the curriculum: science and art teachers can use the learning gardens, outdoor studios, green roof, and surrounding wetlands to support their lessons.

Hubble also achieves the district’s broader environmental goals: it occupies 60,000 fewer square feet than the original Hubble, and significantly cuts the majority of students’ commutes.

Sustainable Features

Building

- Mechanical system 20% more efficient than standard systems
- Green roofs and reflective cool roofs
- Low-flow plumbing fixtures
- Daylight harvesting system
- Building materials with high recycled content
- Built-in educational displays promoting environmental issues

Site

- Drought-resistant landscaping
- Five-acre stormwater basin filled with wetland vegetation
- Parking lot bioswales and permeable pavers
- Outdoor gardens and centrally-located *nature observatory*



Hubble Middle School

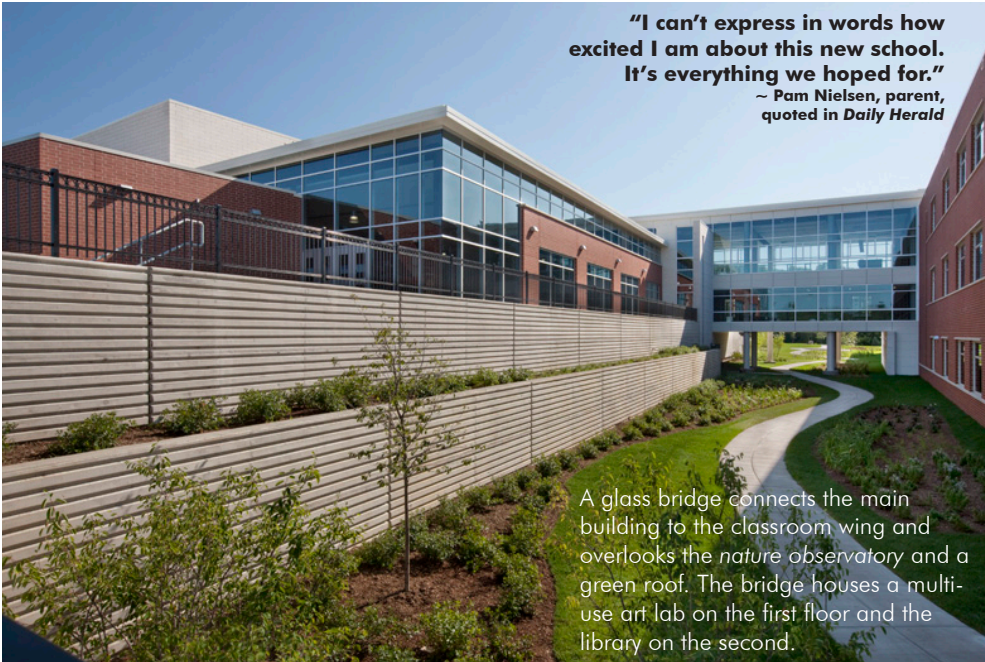

"I can't express in words how excited I am about this new school. It's everything we hoped for."
 ~ Pam Nielsen, parent, quoted in *Daily Herald*

A glass bridge connects the main building to the classroom wing and overlooks the *nature observatory* and a green roof. The bridge houses a multi-use art lab on the first floor and the library on the second.

A Community Connection

One important design goal was to ensure that the new school not only sustain, but enhance the strong relationship with the community that the original Hubble had.

Nearly the entire new Hubble is designated for shared use with the community. An agreement with the Warrenville Park District allows residents to schedule use of the majority of the facility during non-school hours.

Recognition

- Greenbuild Chicago 2010 video, U.S. Green Building Council
- "Cool school," *Chicago Architect*, September/October, 2009
- "Joint facilities: Where everybody benefits," *Building Design + Construction*, June, 2008

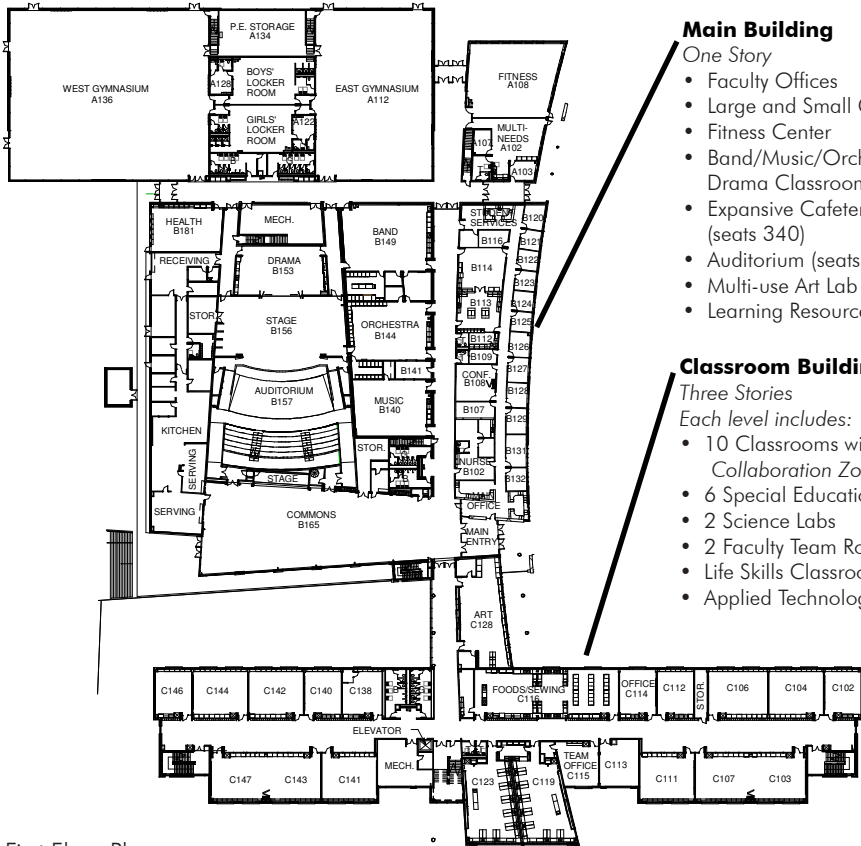

Main Building

- One Story
- Faculty Offices
 - Large and Small Gyms
 - Fitness Center
 - Band/Music/Orchestra/Drama Classrooms
 - Expansive Cafeteria/Commons (seats 340)
 - Auditorium (seats 500)
 - Multi-use Art Lab
 - Learning Resource Center

Classroom Building

- Three Stories
- Each level includes:
- 10 Classrooms with Collaboration Zones
 - 6 Special Education Classrooms
 - 2 Science Labs
 - 2 Faculty Team Rooms
 - Life Skills Classroom
 - Applied Technology Lab

First Floor Plan



Green roof accessible from library



Library