

HENRY W. LONGFELLOW SCHOOL

Community Unit School District 200



The new Longfellow Elementary School, designed for District 200 in Wheaton, was constructed subsequent to intensive concept planning which evaluated options for renovation of the venerable old Longfellow structure versus building anew. The school was built adjacent to their existing facility to allow classes to continue during construction.

Based upon the advantages a new building would bring, the facility was designed and bids were let in June 2000. Construction was completed in summer of 2001 that included demolition of the original school.

The 62,000 sq. ft. school features a two-story classroom wing, centrally located administrative suite, library, art and music rooms, and a gymnasium/MPR wing, which can be secured for nighttime use.

The design reflects a contemporary interpretation of the original building's traditional detailing, and uses brick and limestone that is common in the downtown Wheaton vicinity.

Also under construction in 2001 for the District were renovations to Hawthorne School, \$5,000,000 and Whittier School, \$4,200,000.

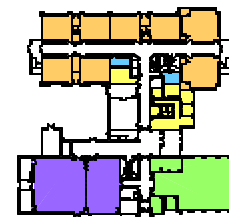

FIRST FLOOR PLAN

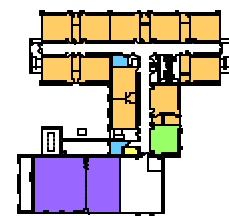

SECOND FLOOR PLAN

- CLASSROOM
- ENCORE SPACES
- SPECIAL STUDIES
- ADMINISTRATION
- ASSEMBLY SPACES



Main Hallway



Gymnasium

Type of Facility	Elementary
Grades	K-5
Gross Area	62,000 SF
Estimated Cost	\$9,000,000
Construction Cost	\$7,994,000
Change Orders	\$169,000
Occupancy	August 2001